

**STORMWATER NOTES:**

- ALL CONSTRUCTION SHALL BE IN ACCORDANCE WITH THE ISPCW LATEST EDITION EXCEPT AS NOTED BELOW.
- UTILITY LOCATIONS ARE APPROXIMATE. CONTRACTOR TO VERIFY THE LOCATION AND ELEVATION OF ALL UTILITIES INCLUDING INVERTS ASSOCIATED WITH PROPOSED CONNECTIONS.
- CONTRACTOR TO COORDINATE INSTALLATION OF ALL SERVICES WITH ASSOCIATED UTILITIES INCLUDING SUBMITTING APPLICATIONS TO AND ACQUIRING PERMITS AS NEEDED.
- CONTRACTOR RESPONSIBLE FOR COORDINATING A TRAFFIC CONTROL PLAN WHEN WORKING WITHIN THE RIGHT OF WAY.
- GRASSED DETENTION AREAS SHALL SERVE AS STORAGE FOR THE 25-YEAR STORM PROVIDING A TOTAL OF 778 CF OF DETENTION VOLUME, BASED OFF OF THE STORMWATER RUNOFF EVALUATION, THE MINIMUM REQUIRED DETENTION VOLUME IS 745 CF.
- DETENTION AREA #1  
 TOP ELEVATION = 2128.20'  
 BOTTOM ELEVATION = 2126.82'  
 8" OUTFLOW PIPE INVERT ELEV. = 2127.52'  
 4:1 SIDE SLOPES  
 LENGTH = 42 LF  
 BOTTOM WIDTH = 10 LF  
 TOP WIDTH = 21.1 LF  
 VOLUME = 376 CF
- DETENTION AREA #2  
 TOP ELEVATION = 2128.30'  
 BOTTOM ELEVATION = 2126.76'  
 8" OUTFLOW PIPE INVERT ELEV. = 2127.60'  
 4:1 SIDE SLOPES  
 LENGTH = 42 LF  
 BOTTOM WIDTH = 8 LF  
 TOP WIDTH = 20 LF  
 VOLUME = 402 CF
- PERFORATED PIPE TO BE 4" SCH 40 AND CENTERED IN FREE DRAINING AGGREGATE ENCOMPASSED IN MIRAFI 140NL OR APPROVED EQUAL.
- CONTRACTOR SHALL CONFIRM EXISTING CATCH BASIN LOCATION AND ELEVATIONS. ELEVATIONS SHOWN PER TRIANGLE DRIVE AS-BUILT PLANS [ITD PROJECT NO. A014 (331)].

**EROSION CONTROL NOTES:**

- INSTALL SILT FENCING PRIOR TO CONSTRUCTION AND PERPENDICULAR TO THE LINE OF FLOW AND AROUND STOCKPILES.
- ALL SURFACES THAT ARE NOT PAVED, GRAVEL TOPPED, PONDS, LANDSCAPED OR WITHIN STRUCTURE FOOTPRINTS ARE TO BE GIVEN A MINIMUM OF 4" OF TOPSOIL AND ARE TO BE SEEDED.
- THE CONTRACTOR IS RESPONSIBLE FOR THESE MEASURES AND FOR THE EPA'S GENERAL CONSTRUCTION PERMIT INCLUDING THE STORMWATER POLLUTION PREVENTION PLAN.
- DUST ABATEMENT WILL BE ACHIEVED USING A WATER TRUCK AS NEEDED AND SHALL BE THE RESPONSIBILITY OF THE CONTRACTOR.
- ALL CULVERTS INSTALLED WITHIN THE LIMITS OF DISTURBANCE SHALL HAVE WATTLES PLACED AROUND THE INLETS IMMEDIATELY AFTER INSTALLATION.
- ROCK CAP FOR APPROACHES TO BE INSTALLED AT THE ONSET OF CONSTRUCTION TO AVOID TRACKING ONTO TRIANGLE DRIVE. ANY OFFSITE TRACKING TO BE CLEANED UP IMMEDIATELY.
- ALL DITCHES AND PONDS TO HAVE A MAX. 3:1 SIDE SLOPE.

**GRADING NOTES:**

- TOC = TOP OF CONCRETE
- EOP = EDGE OF PAVEMENT
- FG = FINISHED GRADE
- FFE = FINISHED FLOOR ELEVATION
- DIRECTION OF FLOW: →→→→→

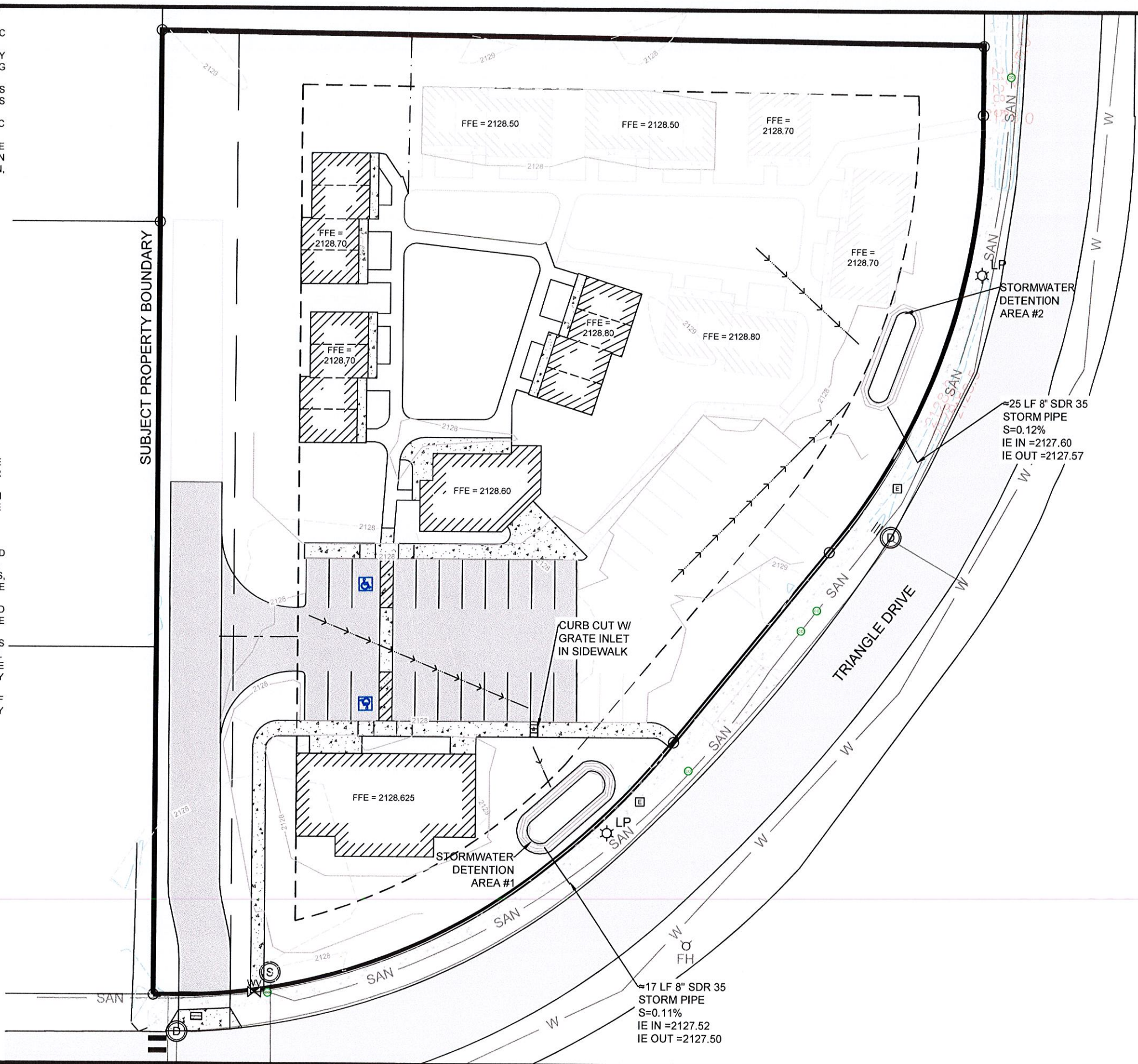

PRELIMINARY  
NOT FOR  
CONSTRUCTION

PROJ. NO.	REVISION	DATE	BY	SHEET
CW163				C-4
DRAWN BY	DATE			
NAIC				
DATE		7/2/2024		

**GOOD SAMARITAN INN**  
**STORMWATER & GRADING**  
**PLAN**

**Clearwater Engineering, LLC**  
 P.O. Box 2006  
 Post Falls, ID 83877  
 Phone: 406.690.5249  
 clearwatereng\_idaho@gmail.com

