

DEMOLITION PLAN
SCALE: 1" = 30'

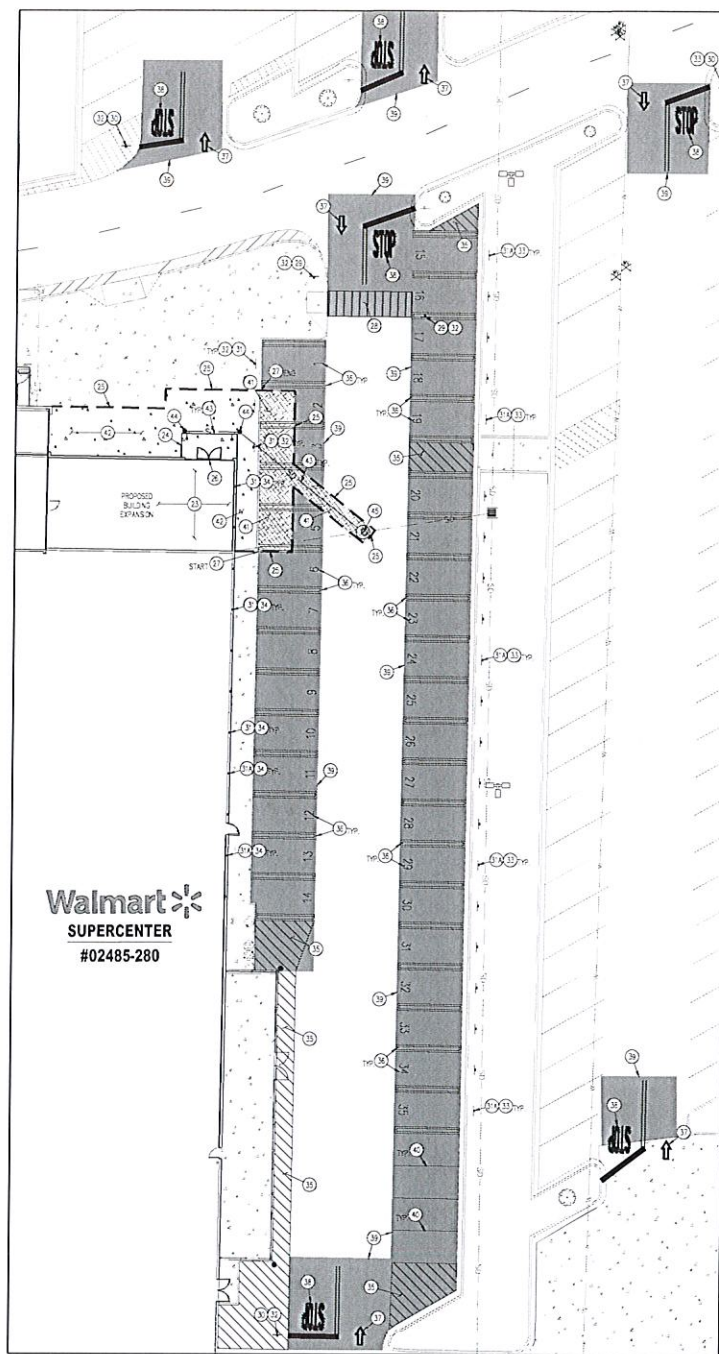

SITE PLAN
SCALE: 1" = 30'

- SITE & DEMOLITION SCHEDULE**
- 1 DEMOLISH WALMART BUILDING TO REMAIN
 - 2 DEMOLISH CONCRETE PAVEMENT/SIDEWALK TO REMAIN
 - 3 DEMOLISH ASPHALT PAVEMENT TO REMAIN
 - 4 DEMOLISH ASPHALT PAVEMENT TO BE REMOVED
 - 5 DEMOLISH CONCRETE PAVEMENT/SIDEWALK TO BE REMOVED
 - 6 DEMOLISH PARKING LOT STRIPING/PAVEMENT MARKINGS TO BE REMOVED
 - 7 DEMOLISH SIGN TO BE REMOVED
 - 8 DEMOLISH CURB AND GUTTER TO BE REMOVED
 - 9 DEMOLISH CURB AND GUTTER TO REMAIN
 - 10 DEMOLISH SIGN POST (AND BOLLS WHERE APPLICABLE) AND POULP SIGNAGE TO BE REMOVED AND SALVAGED FOR RE-USE
 - 11 DEMOLISH WALL-MOUNTED POULP SIGNAGE TO BE REMOVED AND SALVAGED FOR RE-USE
 - 12 DEMOLISH SITE BOLLARD TO REMAIN
 - 13 DEMOLISH PAVEMENT MARKINGS TO REMAIN (RETAIN FOR CURRENT STANARDS AND GUIDELINES)
 - 14 DEMOLISH WATER LINE TO REMAIN
 - 15 DEMOLISH WATER VALVE TO REMAIN
 - 16 DEMOLISH STORM SEWER LINE TO REMAIN AND BE PROTECTED IN PLACE
 - 17 DEMOLISH STORM SEWER ALET TO REMAIN
 - 18 DEMOLISH SANITARY SEWER LINE TO REMAIN
 - 19 DEMOLISH SANITARY SEWER MANHOLE TO REMAIN
 - 20 DEMOLISH SANITARY SEWER CLEANOUT TO REMAIN
 - 21 DEMOLISH LIGHT POLE AND BASE TO REMAIN
 - 22 DEMOLISH SIGN TO REMAIN
 - 23 DEMOLISH SIGNAGE AND BASE TO REMAIN
 - 24 DEMOLISH SIGN TO REMAIN
 - 25 DEMOLISH ASSOCIATE CANOPY AND COLUMNS (REF ARCH PLANS)
 - 26 DEMOLISH SIGNLIGHT OF EXISTING PAVEMENT
 - 27 DEMOLISH POULP LOOP (REF ARCH PLANS)
 - 28 DEMOLISH CURB AND GUTTER (REF PAVEMENT DETAILS)
 - 29 DEMOLISH ASSOCIATE PATH CROSSWALK STRIPING (REF SITE DETAILS)
 - 30 DEMOLISH 8'-10" x 8'-10" STOP HERE FOR PEDESTRIAN SIGNAGE (REF SITE DETAILS)
 - 31 DEMOLISH 30'x30' STOP SIGN (REF SITE DETAILS)
 - 32 SALVAGED RE-INSTALLED POULP SIGNAGE (SIGNS 1-10)
 - 33 DEMOLISH POULP SIGNAGE, SIGNS 11-35 (REF SITE DETAILS)
 - 34 DEMOLISH STORM SEWER ALET TO REMAIN
 - 35 DEMOLISH SANITARY SEWER LINE TO REMAIN
 - 36 DEMOLISH SANITARY SEWER MANHOLE TO REMAIN
 - 37 DEMOLISH SANITARY SEWER CLEANOUT TO REMAIN
 - 38 DEMOLISH LIGHT POLE AND BASE TO REMAIN
 - 39 DEMOLISH SIGN MOUNTING BREAKAWAY POST OF BOLLARD POST
 - 40 DEMOLISH WATERLINE TO REMAIN
 - 41 DEMOLISH SANITARY SEWER LINE TO REMAIN
 - 42 DEMOLISH SANITARY SEWER STRUCTURE TO REMAIN
 - 43 DEMOLISH WATER VALVE TO REMAIN
 - 44 DEMOLISH STORM SEWER LINE TO REMAIN
 - 45 DEMOLISH STORM SEWER ALET TO REMAIN
 - 46 DEMOLISH SEWER LINE
 - 47 DEMOLISH WALMART BUILDING
 - 48 DEMOLISH WALMART BUILDING TO REMAIN
 - 49 DEMOLISH STORM SEWER LAC
 - 50 DEMOLISH STORM SEWER CLEANOUT
 - 51 DEMOLISH STORM SEWER WHIMBLE

- 34 PROPOSED SIGN MOUNTING AND BASE WITH BOLLARD (REF SITE DETAILS)
- 35 PROPOSED SIGN MOUNTING AND BASE WITH BREAKAWAY POST (REF SITE DETAILS)
- 36 PROPOSED WALL-MOUNTED SIGNAGE (REF SITE DETAILS)
- 37 PROPOSED 4" SOLID WHITE PAINTED STRIPES AT 45° @ 2'-4" O.C.
- 38 PROPOSED POULP STALL STRIPING AND POULP NUMBER MARKING (REF SITE DETAILS)
- 39 PROPOSED OPEN ARROW PAVEMENT MARKINGS (REF SITE DETAILS)
- 40 PROPOSED STOP SIGN AND STOP BAR PAVEMENT MARKINGS (REF SITE DETAILS)
- 41 PROPOSED SEAL COAT OF EXISTING PAVEMENT
- 42 PROPOSED STANDARD STALL STRIPING STALLS TO BE 8'-6" X 4" WIDE, YELLOW STRIPING
- 43 PROPOSED ASPHALT PAVEMENT (REF PAVEMENT DETAILS)
- 44 PROPOSED CONCRETE PAVEMENT/SIDEWALK (REF PAVEMENT DETAILS)
- 45 PROPOSED 8" STORM SEWER LINE
- 46 PROPOSED STORM SEWER CLEANOUT (REF SITE DETAILS)
- 47 PROPOSED STORM SEWER MANHOLE (REF SITE DETAILS)

PARKING TABLE

PARKING COUNT BASED ON AVAILABLE AERIAL IMAGERY, FIELD VERIFICATION REQUIRED.

	EXISTING	PROPOSED
BUILDING AREA (SF)	137,350	138,878
PARKING REQUIREMENT	1 SPACE / 232 SQ. FT.	1 SPACE / 230 SQ. FT.
PARKING REQUIRED	797	792
STANDARD STALLS	728	699
ADA STALLS	15	15
POULP STALLS	10	35
TOTAL PARKING STALLS	797	753
PARKING RATIO	4.8 SPACES / 1,000 SF	4.75 SPACES / 1,000 SF

SITE INFORMATION
 TOTAL SITE AREA: 14.64 ACRES
 PROPOSED BUILDING SQUARE FOOTAGE: 158,378 SQ. FT. / 3.64 ACRES
 OPEN SPACE: 358,035 SQ. FT. / 8.22 ACRES
 GREEN SPACE: 129,929 SQ. FT. / 2.95 ACRES

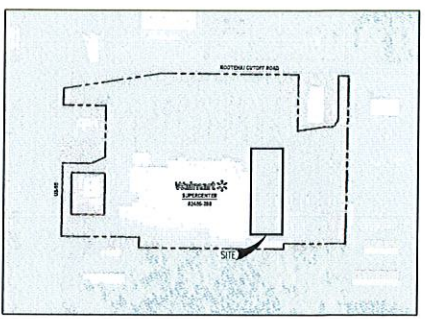

KEY MAP
SCALE: 1" = 300'

- LEGEND**
- EXISTING CURB AND GUTTER TO REMAIN
 - PROPOSED CURB AND GUTTER
 - EXISTING CURB AND GUTTER TO BE REMOVED
 - EXISTING CONCRETE PAVEMENT TO REMAIN
 - PROPOSED CONCRETE PAVEMENT/SIDEWALK
 - EXISTING ASPHALT PAVEMENT TO REMAIN
 - EXISTING ASPHALT PAVEMENT TO BE REMOVED
 - PROPOSED ASPHALT PAVEMENT
 - EXISTING CONCRETE PAVEMENT/SIDEWALK TO BE REMOVED
 - PROPOSED SEAL COAT
 - EXISTING BOLLARD TO REMAIN
 - EXISTING LIGHT POLE TO REMAIN
 - EXISTING SIGNAGE TO BE REMOVED
 - PROPOSED SIGN MOUNTING BREAKAWAY POST OF BOLLARD POST
 - EXISTING WATERLINE TO REMAIN
 - EXISTING SANITARY SEWER LINE TO REMAIN
 - EXISTING SANITARY SEWER STRUCTURE TO REMAIN
 - EXISTING WATER VALVE TO REMAIN
 - EXISTING STORM SEWER LINE TO REMAIN
 - EXISTING STORM SEWER ALET TO REMAIN
 - PROPOSED SEWER LINE
 - PROPOSED WALMART BUILDING
 - EXISTING WALMART BUILDING TO REMAIN
 - PROPOSED STORM SEWER LAC
 - PROPOSED STORM SEWER CLEANOUT
 - PROPOSED STORM SEWER WHIMBLE

SITE NOTES

- ALL WORK AND MATERIALS SHALL COMPLY WITH ALL CITY/COUNTY REGULATIONS AND CODES AND DESIGN STANDARDS.
- CONTRACTOR SHALL REFER TO THE ARCHITECTURAL PLANS FOR EXACT LOCATIONS AND DIMENSIONS OF UTILITIES, SIGNAGE, POULP, SIGNPOSTS, TRUCK DOORS, PREISE BUILDING DIMENSIONS AND EXISTING UTILITIES IN EXISTING LOCATIONS.
- ALL DIMENSIONS ARE TO THE FACE OF CURB UNLESS OTHERWISE NOTED.
- EXISTING STRUCTURES WITHIN CONSTRUCTION LIMITS ARE TO BE ABANDONED, REMOVED OR RELOCATED AS NECESSARY. ALL COST SHALL BE INCLUDED IN BIDS.
- CONTRACTOR SHALL BE RESPONSIBLE FOR ALL RELOCATIONS (UNLESS OTHERWISE NOTED ON PLANS) INCLUDING BUT NOT LIMITED TO ALL UTILITIES, STORM SEWER, SANITARY SEWER, SIGNAGE, POULP, SIGNPOSTS, ETC. AS REQUIRED. ALL WORK SHALL BE IN ACCORDANCE WITH GOVERNING AGENCIES REQUIREMENTS AND PERMIT SITE WORK SPECIFICATIONS AND SHALL BE APPROVED BY SUCH. ALL COST SHALL BE INCLUDED IN BIDS.
- THE SITE WORK FOR THIS PROJECT SHALL MEET OR EXCEED THE SITE SPECIFICATIONS.
- ALL LIGHT POLES SHALL BE REPAIRED, AND ALL SIGNAGE REPAIRED BEFORE WORK OR DEMOLITION OF NEW OVERHEAD OR SURROUNDING PAVEMENT SHALL BE REMOVED. SEE ARCHITECTURAL SPECIFICATION SECTION 33000 FOR ADDITIONAL INFORMATION.
- REPAIRS TO EXISTING PARKING LOT STRIPING AND MARKINGS WITHIN EXISTING EXCEPT WHERE NOTED IN THESE DRAWINGS OR SIGN PLAN SET (SEPARATE PLAN SET) SHALL BE IN ACCORDANCE WITH THE SPECIFICATIONS PROVIDED WITH THIS PLAN SET.

DEMOLITION NOTES

- THE CONTRACTOR IS RESPONSIBLE FOR THE DEMOLITION, REMOVAL, AND DISPOSAL (IN A LOCATION APPROVED BY ALL GOVERNING AGENCIES) ALL STRUCTURES, FENCE WALLS, FOUNDATIONS, PAVEMENT, DRIVEWAYS, SIGNAGE STRUCTURES, UTILITIES, ETC., SUCH THAT THE UNDERPINNINGS OF THE PROPOSED PLANS CAN BE CONSTRUCTED. ALL FACILITIES TO BE REMOVED SHALL BE ABANDONED TO SUITABLE MATERIAL AND BROUGHT TO GRADE WITH SUITABLE COMPACTED FILL MATERIAL PER THE SPECIFICATIONS PRIOR TO DEMOLITION OCCURRING. ALL EROSION CONTROL DEVICES ARE TO BE INSTALLED.
- THE CONTRACTOR IS RESPONSIBLE FOR OBTAINING ALL PERMITS REQUIRED FOR DEMOLITION AND DISPOSAL.
- THE CONTRACTOR SHALL COORDINATE WITH RESPECTIVE UTILITY COMPANIES PRIOR TO THE REMOVAL AND/OR RELOCATION OF UTILITIES. THE CONTRACTOR SHALL COORDINATE WITH THE UTILITY COMPANIES CONCERNING PERMITS FOR WORK WHICH MAY BE PERFORMING BY THE UTILITY COMPANIES THEMSELVES AND ANY FEES WHICH ARE TO BE PAID TO THE UTILITY COMPANIES FOR THEIR SERVICES. THE CONTRACTOR IS RESPONSIBLE FOR PAYING ALL FEES AND CHARGES.
- THE LOCATIONS OF ALL EXISTING UTILITIES SHOWN ON THIS PLAN HAVE BEEN DETERMINED FROM THE BEST INFORMATION AVAILABLE AND ARE GIVEN FOR THE CONVENIENCE OF THE CONTRACTOR. THE ENGINEER ASSUMES NO RESPONSIBILITY FOR THEIR ACCURACY PRIOR TO THE START OF ANY DEMOLITION ACTIVITY. THE CONTRACTOR SHALL NOTIFY THE UTILITY COMPANIES FOR MARKING EXISTING LOCATIONS OF EXISTING UTILITIES.
- ALL EXISTING SIGNAGE AND UTILITIES SHOWN ARE NOT TO BE INTERFERED AS THE EXACT LOCATION OR AS THE ONLY OBSTACLES THAT MAY OCCUR ON THE SITE. VERIFY EXISTING CONDITIONS AND PROCEED WITH CAUTION REGARDING ANY UNEXPECTED STRUCTURES. GIVE NOTICE TO ALL UTILITY COMPANIES REGARDING DEMOLITION AND REMOVAL OF ALL SERVICE LINES AND CAP ALL LINES BEFORE PROCEEDING WITH THE WORK. UTILITIES DETERMINED TO BE ABANDONED AND LEFT IN PLACE SHALL BE PROTECTED FROM BEING DAMAGED. CONTRACTOR MUST PROTECT THE PUBLIC AT ALL TIMES WITH FENCING, BARRELS, CONES, ETC., AND OTHER APPROPRIATE BEST MANAGEMENT PRACTICES AS APPROVED BY CITY AND OTHER. SHOULD REMOVAL AND/OR RELOCATION ACTIVITIES DAMAGE EXISTING FACILITIES TO REMAIN, THE CONTRACTOR SHALL PROVIDE NEW MATERIALS/STRUCTURES IN ACCORDANCE WITH THE CONTRACT DOCUMENTS EXCEPT FOR MATERIALS DESIGNATED TO BE REMOVED ON THIS PLAN. ALL OTHER CONSTRUCTION MATERIALS SHALL BE NEW. DAMAGE TO ALL EXISTING CONDITIONS TO REMAIN WILL BE REPLACED AT CONTRACTOR'S EXPENSE.
- CONTRACTOR SHALL LIMIT SIGN-CURTAIN PAVEMENT REMOVAL TO ONLY THOSE AREAS WHERE IT IS REQUIRED AS SHOWN ON THESE CONSTRUCTION PLANS. SIGN-POSTS SHALL BE REMOVED FROM ALL SURROUNDING PAVEMENT. THE CONTRACTOR SHALL BE RESPONSIBLE FOR ITS REMOVAL AND REPAIR.
- IT IS THE CONTRACTOR'S RESPONSIBILITY TO CONTACT THE VARIOUS UTILITY COMPANIES WHICH MAY HAVE BURIED AERIAL UTILITIES WITHIN OR NEAR THE CONSTRUCTION AREA BEFORE COMMENCING WORK. THE CONTRACTOR SHALL PROVIDE TO THE UTILITY COMPANIES NOTICE TO ALL UTILITY COMPANIES PRIOR TO BEGINNING CONSTRUCTION.
- ALL EXISTING UTILITIES SHOWN ARE LOCATED ACCORDING TO THE INFORMATION AVAILABLE TO THE ENGINEER AT THE TIME THE DRAWINGS WERE PREPARED AND HAVE NOT BEEN INDEPENDENTLY VERIFIED BY THE OWNER OR THE ENGINEER. CONTRACTOR IS NOT MADE THAT ALL EXISTING UNDERGROUND UTILITIES ARE SHOWN OR THAT THE LOCATION OF THOSE SHOWN ARE ACCURATE. FINDING THE ACTUAL LOCATION OF ANY EXISTING UTILITIES IS THE CONTRACTOR'S RESPONSIBILITY AND SHALL BE DONE BEFORE THE COMMENCEMENT OF ANY WORK IN THE PROJECT. FURTHERMORE, THE CONTRACTOR SHALL BE SOLELY RESPONSIBLE FOR ANY AND ALL DAMAGE DUE TO THE CONTRACTOR'S FAILURE TO EXACTLY LOCATE AND PRESERVE ANY AND ALL UNDERGROUND UTILITIES. THE OWNER OR ENGINEER WILL ASSUME NO LIABILITY FOR ANY DAMAGE SUSTAINED BY THE CONTRACTOR OR CAUSED BY THE OPERATIONS OF THE CONTRACTOR OR STRUCTURES WORK FOR TEMPORARY BRACING AND SHORING OF SIGN. IF IT IS NECESSARY TO SHOR, BRACE, TEND OR RELOCATE A UTILITY, THE UTILITY COMPANY OR DEPARTMENT AFFECTED SHALL BE CONTACTED BY THE CONTRACTOR AND PERMITS OBTAINED REGARDING THE METHOD TO USE FOR SUCH WORK.
- THE CONTRACTOR SHALL HAVE AVAILABLE AT THE JOB SITE AT ALL TIMES ONE COPY OF THE CONTRACT DOCUMENTS INCLUDING PLANS, SPECIFICATIONS, COPIES OF ANY REQUIRED CONSTRUCTION PERMITS, AND EROSION CONTROL PLANS AND INSPECTION REPORTS (DWPPP).
- ANY DISCREPANCIES ON THE DRAWINGS SHALL BE IMMEDIATELY REPORTED TO THE ATTENTION OF THE OWNER/PURCHASER BEFORE COMMENCING WORK. NO FIELD CHANGES OR DECISIONS FROM DESIGN ARE TO BE MADE WITHOUT THE APPROVAL OF THE OWNER AND NOTIFICATION TO THE ENGINEER. NO CONSTRUCTION WILL BE GIVEN TO CHANGE ORDERS FOR WHICH THE OWNER AND ENGINEER WERE NOT CONTACTED PRIOR TO CONSTRUCTION OF THE PROJECT ITEM.
- CONTRACTOR SHALL COMPLY TO THE FULLEST EXTENT WITH THE LATEST OSHA STANDARDS FOR DEMOLITION AND TRENCHING PROCEDURES. CONTRACTOR SHALL USE SAFETY BARRIERS, SIGNS, BARRIERS, ETC. AS NECESSARY FOR THESE OPERATIONS AND SHALL COMPLY WITH ALL OSHA PERFORMANCE STANDARDS.
- DO NOT INTERRUPT EXISTING UTILITIES SERVING FACILITIES OCCUPIED AND USED BY THE OWNER OR OTHERS DURING OBTAINED HOURS EXCEPT WHEN SUCH INTERRUPTIONS HAVE BEEN AUTHORIZED IN WRITING BY THE OWNER AND THE LOCAL JURISDICTION'S INTERFERENCES SHALL ONLY OCCUR AFTER ACCEPTABLE TEMPORARY SERVICE HAS BEEN PROVIDED.
- ANY RECYCLED MATERIAL TO BE STOCKPILED ON THE SITE SHALL BE STORED IN AN AREA AS PRACTICAL AND THE LOCATION OF ANY STOCKPILE SHALL BE WELL CLEAR OF THE BUILDING PAD AREA AND THE LOCATION MUST BE PRE-APPROVED BY THE ENGINEER AND OWNER PRIOR TO STOCKPIPING.
- QUANTITIES SHOWN WERE APPROXIMATE AND ARE PROVIDED FOR CONVENIENCE ONLY AND NOT FOR BID PURPOSES. CONTRACTOR SHALL VERIFY QUANTITIES NECESSARY TO DEMOLITION WORK.
- ABSENCES OF HAZARDOUS MATERIAL, IF FOUND ON SITE, SHALL BE REMOVED BY A LICENSED HAZARDOUS MATERIAL CONTRACTOR. REFER TO ARCHITECTURAL PLANS FOR LIMITS OF BUILDING DEMOLITION.

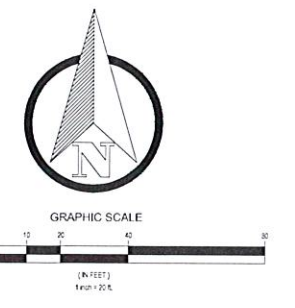

CAUTION - NOTICE TO CONTRACTOR

- ALL UTILITY LOCATIONS SHOWN ARE BASED ON WORK PROVIDED BY THE APPROPRIATE UTILITY COMPANY AND FIELD SURFACE EVIDENCE AT THE TIME OF SURVEY AND IS TO BE CONSIDERED AN APPROXIMATE LOCATION ONLY. IT IS THE CONTRACTOR'S RESPONSIBILITY TO FIELD VERIFY THE HORIZONTAL AND VERTICAL LOCATION OF SUCH EXISTING UTILITY EITHER THROUGH PERFORMANCE OR ALTERNATIVE METHOD. REPORT INFORMATION TO THE ENGINEER PRIOR TO CONSTRUCTION.
- WHERE A PROPOSED UTILITY CROSSERS AN EXISTING UTILITY, IT IS THE CONTRACTOR'S RESPONSIBILITY TO FIELD VERIFY THE HORIZONTAL AND VERTICAL LOCATION OF SUCH EXISTING UTILITY EITHER THROUGH PERFORMANCE OR ALTERNATIVE METHOD. REPORT INFORMATION TO THE ENGINEER PRIOR TO CONSTRUCTION.

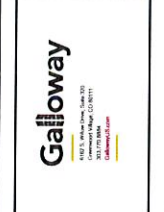

STIPULATION FOR REUSE
 THIS DRAWING IS THE PROPERTY OF GATEWAY ENGINEERING, INC. AND IS TO BE USED ONLY FOR THE PROJECT AND SITE SPECIFICALLY IDENTIFIED HEREON. IT IS NOT TO BE REPRODUCED, COPIED, OR TRANSMITTED IN ANY FORM OR BY ANY MEANS, ELECTRONIC OR MECHANICAL, INCLUDING PHOTOCOPYING, RECORDING, OR BY ANY INFORMATION STORAGE AND RETRIEVAL SYSTEM, WITHOUT THE WRITTEN PERMISSION OF GATEWAY ENGINEERING, INC. ANY UNAUTHORIZED REUSE OR MODIFICATION OF THIS DRAWING SHALL BE AT THE USER'S SOLE RISK AND WITHOUT LIABILITY TO GATEWAY ENGINEERING, INC.



ISSUE BLOCK

NO.	DESCRIPTION	DATE

CHECKED BY: RCL
 DRAWN BY: SH-
 PHOTO CRYL: PH-
 DOCUMENT DATE: 03/28/2023



DEMOLITION AND SITE PLAN

SHEET: **CS1**