

LOT SIZE = 2.10 AC.
 EXISTING IMPERVIOUS AREA = 0.0 AC.
 PROPOSED ADDITIONAL IMPERVIOUS AREA = 0.90 AC.
 TOTAL IMPERVIOUS AREA = 0.90 AC.
 OPEN SPACE = 1.92 AC. = 91%
 GREEN SPACE = 0.37 AC. = 17%
 EXISTING BUILDING FLOOR AREA = 0.0 SF = 0.0 AC.
 NEW BUILDING FLOOR AREA = 7,913 SF = 0.18 AC.
 TOTAL BUILDING FLOOR AREA = 0.18 AC.

SITE NOTES:
 1. CONCRETE APPROACH MUST BE 6" THICK CONCRETE. EXISTING SIDEWALK TO BE REMOVED AND REPLACED WITHIN APPROACH.

LIGHTING NOTES:
 1. PROPOSED EXTERIOR LIGHTING CONSISTS OF BUILDING MOUNTED LIGHTS AS SHOWN.

SIGNAGE NOTES:
 1. TRAFFIC SIGN SHALL DENOTE "ONE-WAY" TRAFFIC INCLUDING AN ARROW DIRECTING TRAFFIC TO KEEP LEFT AT THE FORK.
 2. MONUMENT SIGN SHALL CONFORM TO PCC 7-6-12 AND BE CONSTRUCTED OF APPROVED MATERIALS PER PCC 7-6-6.

LANDSCAPE NOTES:
 1. TREES AND SHRUBS ARE PROPOSED ALONG TRIANGLE DRIVE AS SHOWN.
 2. ALL UNDEVELOPED AREAS WITHIN THE LIMITS OF DISTURBANCE SHALL BE SEEDED UPON COMPLETION OF CONSTRUCTION.
 3. THE GREEN SPACE AREA CONSISTS OF ALL SEEDED AREA WITHIN THE LIMITS OF DISTURBANCE AS WELL AS THE GRASSED INFILTRATION AREAS AND PROPOSED GARDEN.

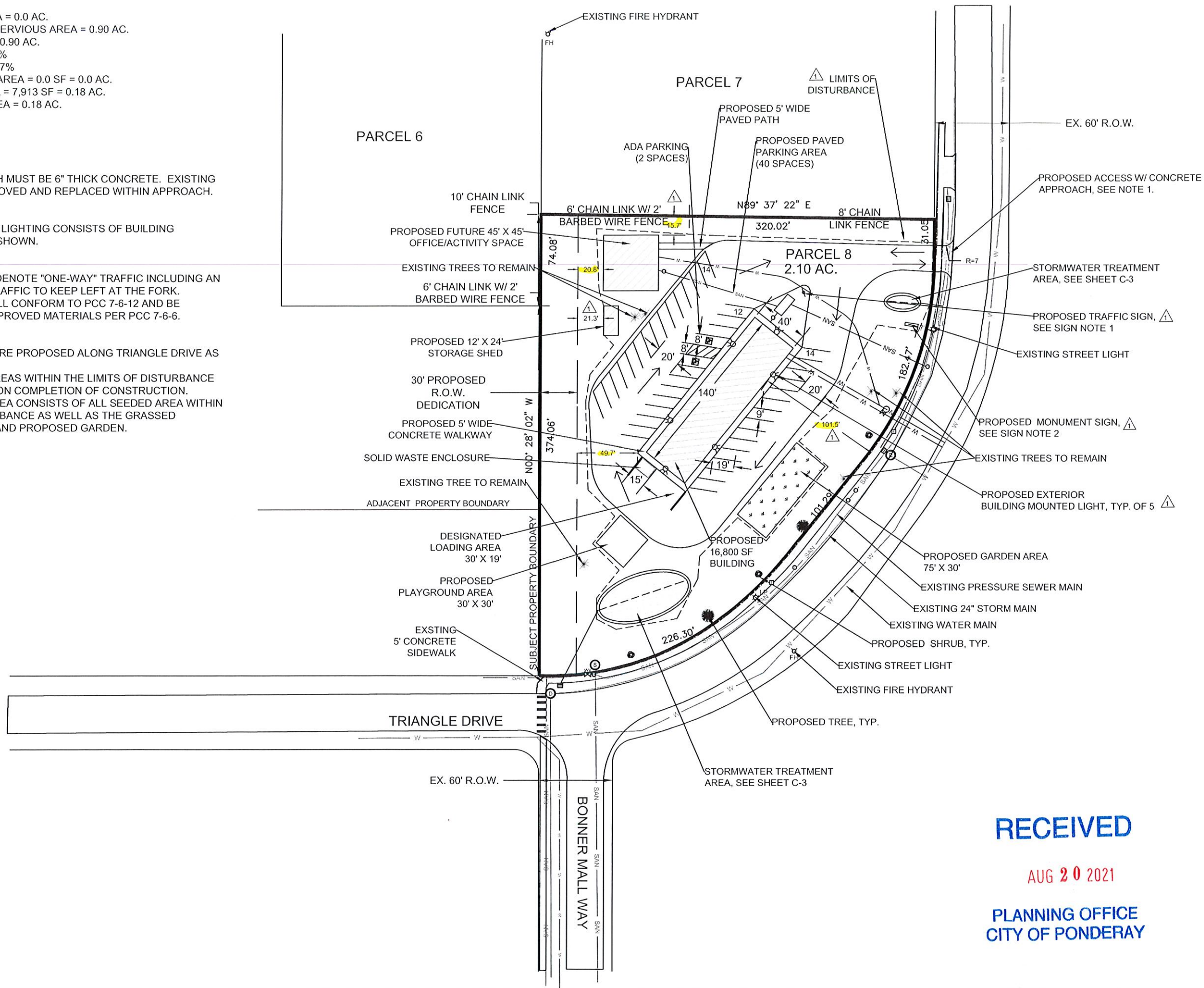

REVISION	8-19-21	DATE	NMC	BY	DATE	BY
CW163	07/29/2021	DATE	NMC	BY	1 OF 3	SHEET
						C-1
						DWG. NO.

**HELPING HANDS HEALING
 HEARTS SITE DESIGN
 SITE PLAN**

CLEARWATER ENGINEERING
 PLANNING, DESIGN, CONSTRUCTION MGMT.
 P.O. BOX 251, SANDPOINT, IDAHO 83864
 (208)255-8803

RECEIVED
 AUG 20 2021
 PLANNING OFFICE
 CITY OF PONDERAY

