

PRELIMINARY PLAT

McNEARNEY MILL

PONDERAY, IDAHO

RPP00000028002A aka 2-57N-2W N 440FT OF W 495 OF SE4 LESS S 220FT OF W 160FT,

Section 2, Township 57 North, Range 2 West,

Boise Meridian, Bonner County, 300 McNearney Road, Ponderay, Idaho

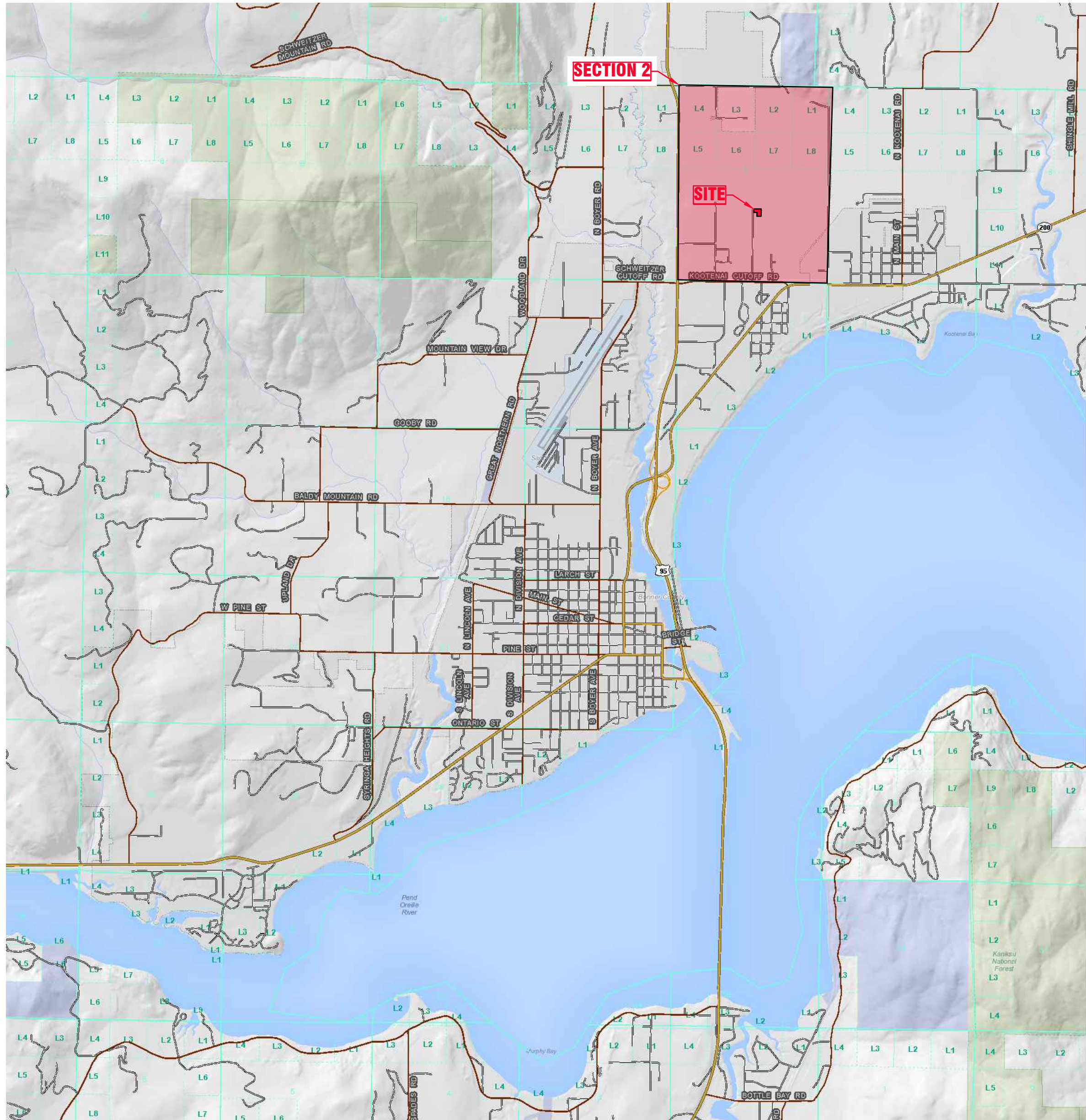

PROJECT VICINITY (SECTION GRID)

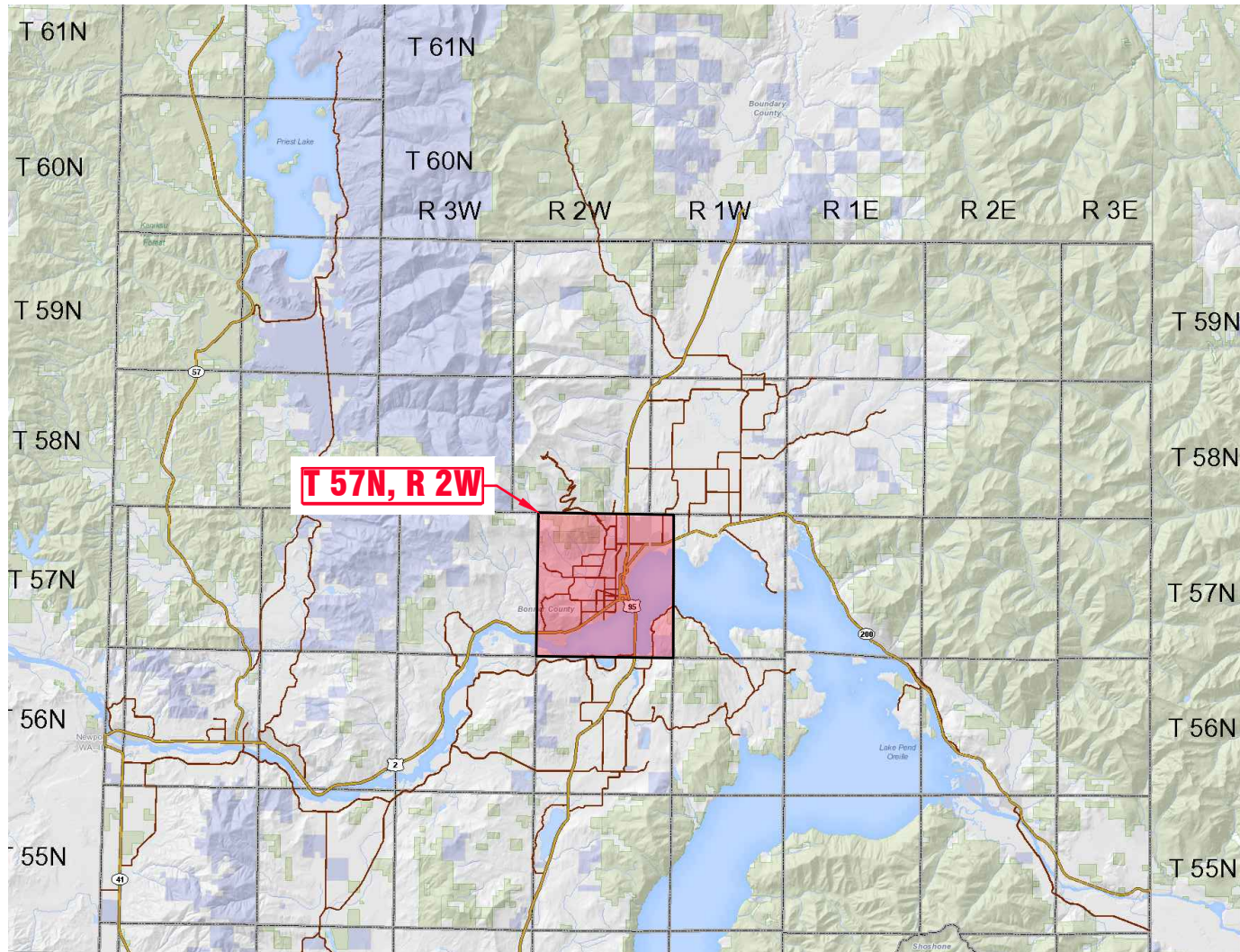

PROJECT VICINITY (STATE GRID)

OWNERS
PHILLIP MCNEARNEY
and
JOYCE BROADSWORD

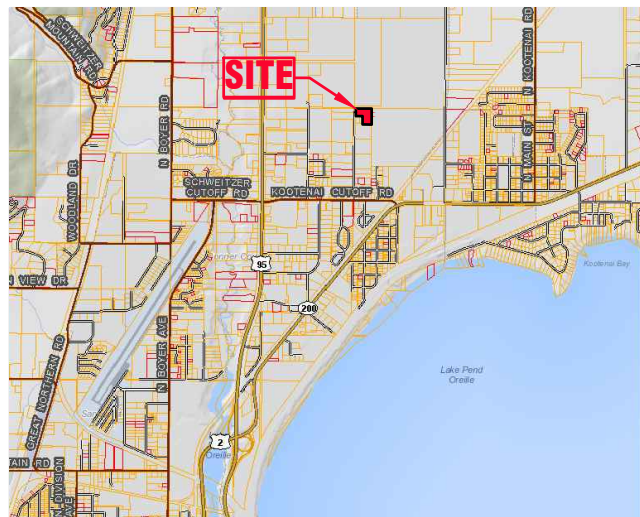

PROJECT VICINITY (LOCAL)



414 CHURCH STREET, SUITE 205 F
SANDPOINT, ID 83864
(208) 914-4833
7B.Engineering@gmail.com

PROJECT NO: 1810
DRAWN BY: DWL
CHECKED BY: DWL
SCALE: NTS (11"x17" ONLY)
SHEET: 1 OF 2

